

WARNING! PLEASE READ BEFORE ASSEMBLING UNIT:

This product is not a toy.
This product is suitable for children 3+ years.
Assembly is to be carried out by a competent adult only.
During assembly children should be kept away from the product to avoid risk of injury.
DO NOT use this item if any components are missing or damaged.
Lifting and closing the lid of this Toy Chest should be carried out under adult supervision.
Ensure that hands and fingers are clear when closing the lid.
Do not stand on the Toy Chest.
Do not sit on the Toy Chest.
Do not climb into the Toy Chest.
Maximum weight loading for this unit is 10KG, evenly distributed.
Regularly check all fastenings to ensure they are properly tightened.
Please retain these instructions for future reference.

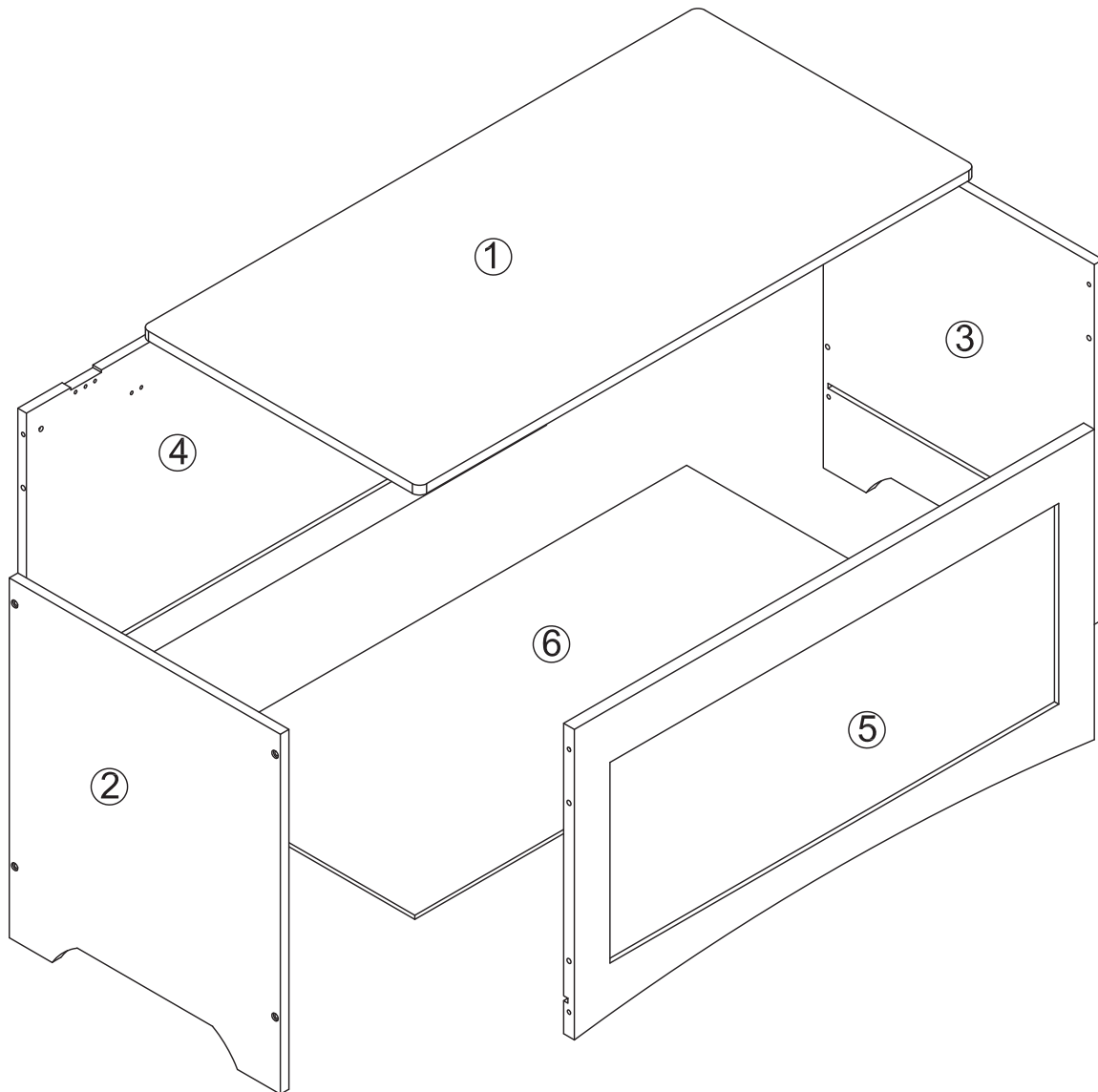

Parts List



A x8pcs



B x8pcs



C x8pcs



D x18pcs



E x3pcs



F x2pcs



G x1pc



H x8pcs



I x16pcs

Step 1

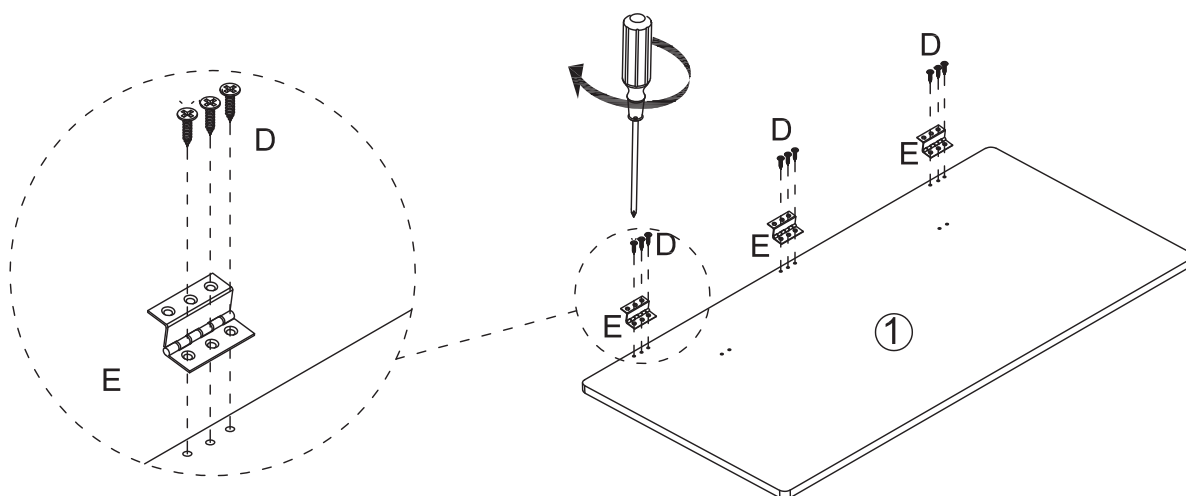

Step 2

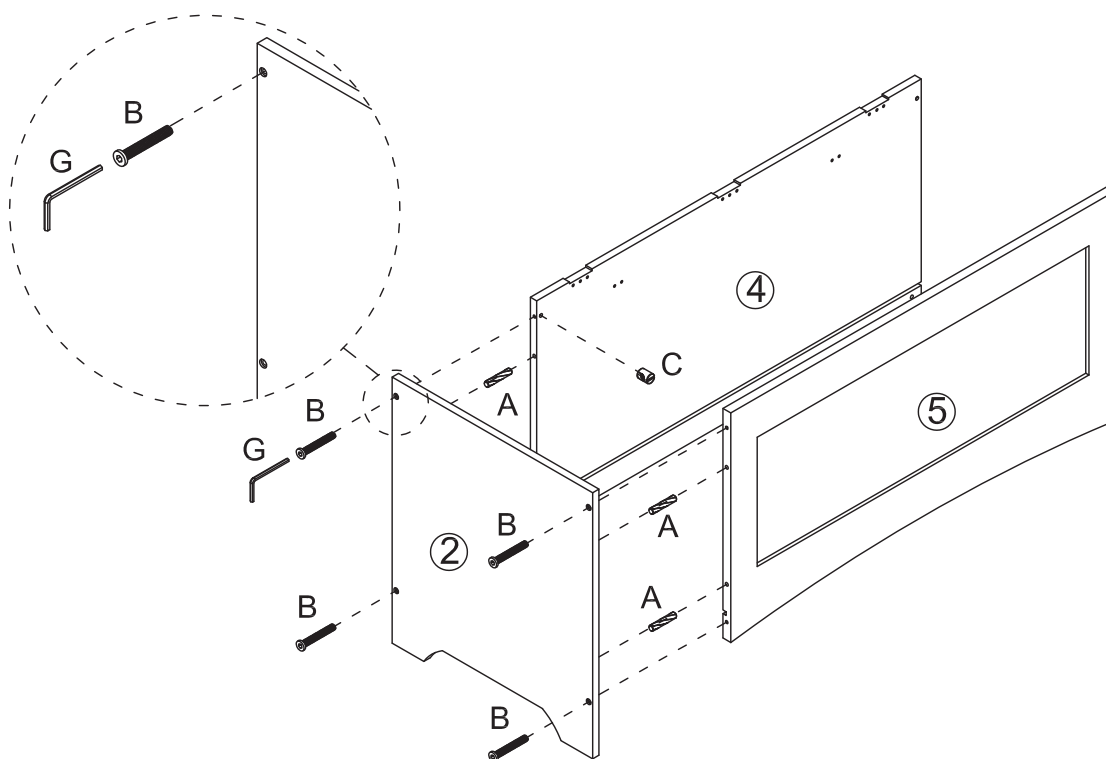

Step 3

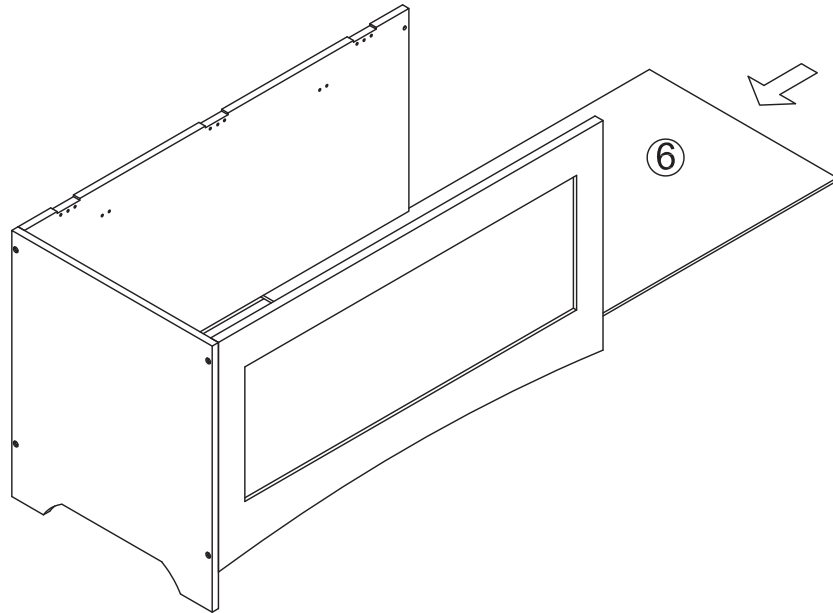

Step 4

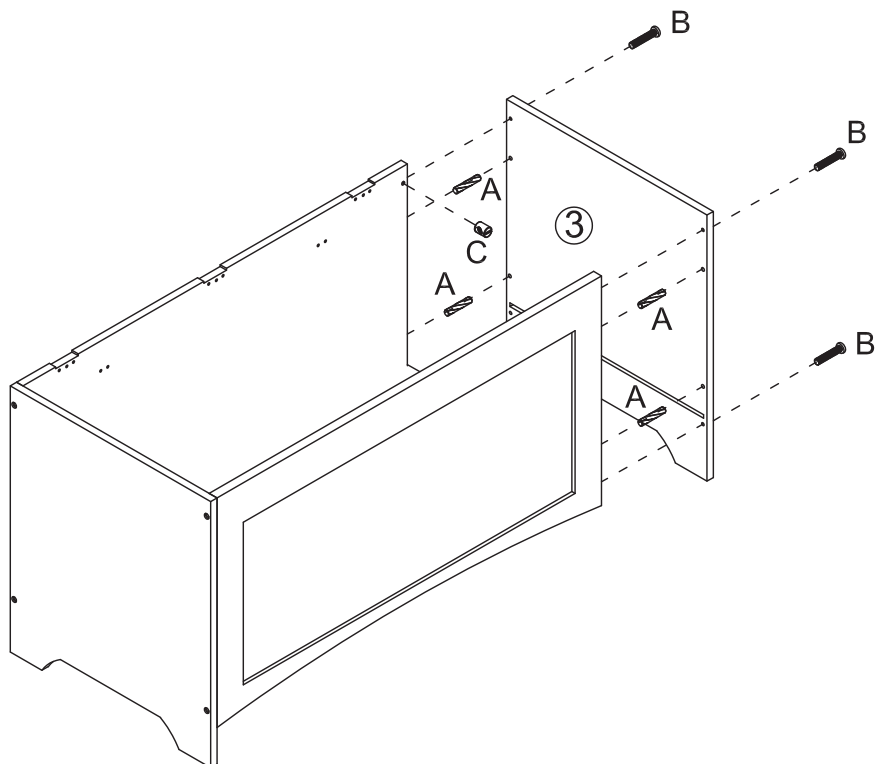

Step 5

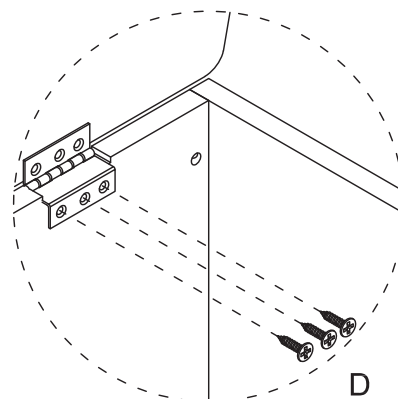
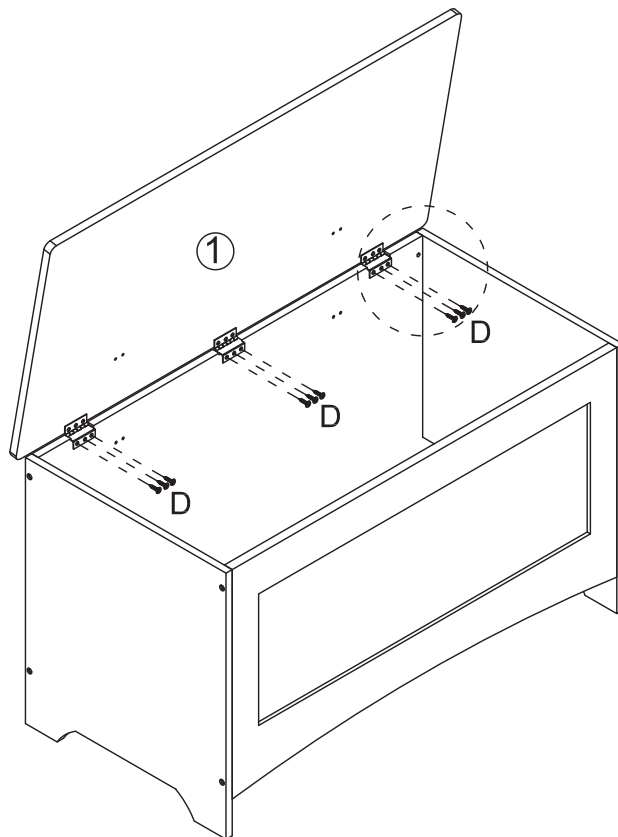

Step 6

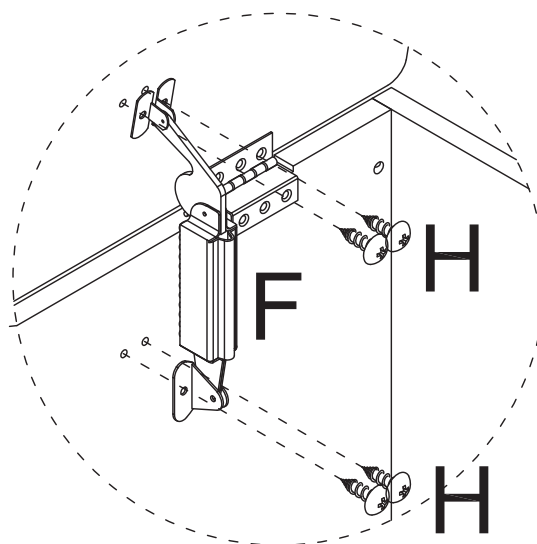
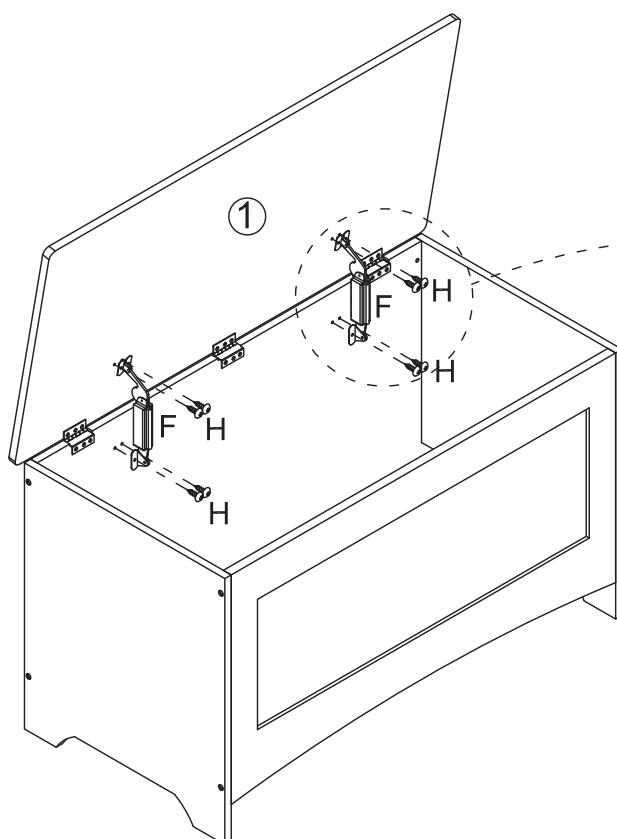

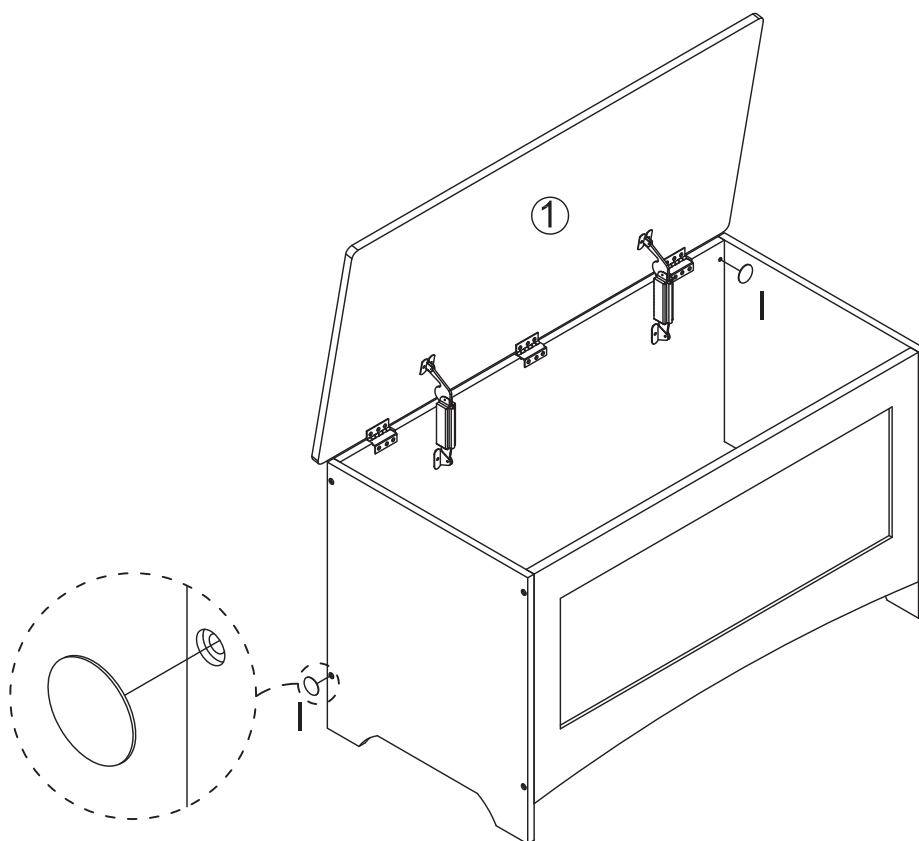

I x16

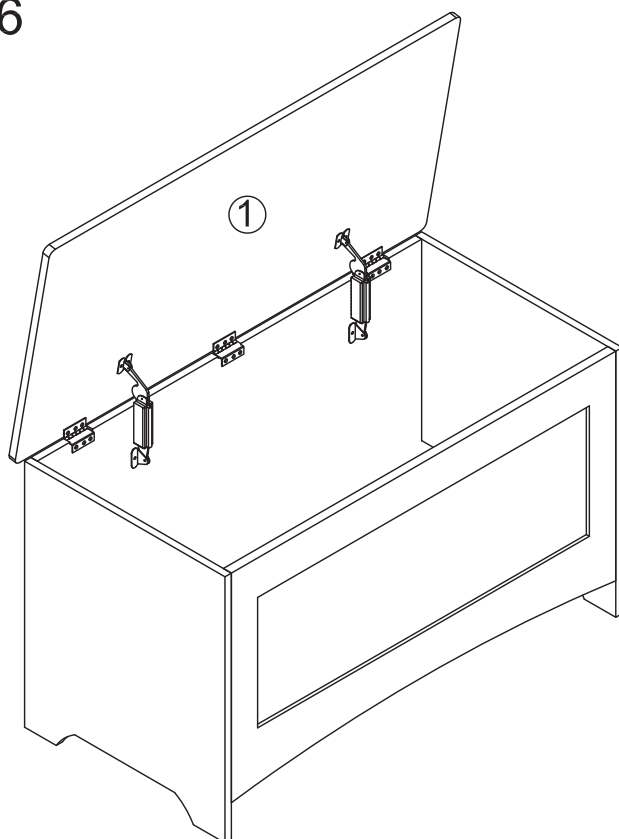

DISTRIBUTED BY:

Visy Retail Services Pty Ltd (AU): 1300 734 714

Visy Board Limited (NZ): 0800 443 058

flexistorage.com.au

flexistorage.co.nz

⚠ WARNING

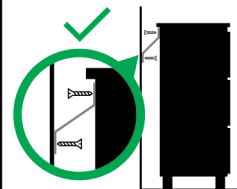

Children have died from furniture tipover.

- ALWAYS secure this furniture with an anchor device.
- NEVER allow children to stand, climb or hang on drawers, doors, or shelves.
- NEVER open more than one drawer at a time.
- Place heavy items down low.

NEVER put a TV on this furniture

